

Garageflex Assembly Instructions

Product: Ceiling Hooks

For use with:



FX9000 D Hanger Hook



FX9001 C Hanger Hook



FX9002 Ring Hanger Hook

Package Contents:

- 1 x Hook of your chosen kind
- 1 x Knob
- 1 x Threaded Connector
- 1 x Channel Nut

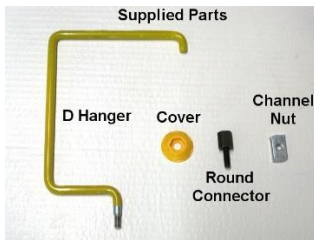

Tools Required: None

Step 1: Check the parts received

Step 2: Screw the hook onto the threaded connector and tighten



Unit 11 Westfield Farm
Medmenham
Buckinghamshire
SL7 2TA

01491 579975 | info@garageflex.co.uk
www.garageflex.co.uk

Step 3: Slip the knob onto the connector and screw the channel nut onto the connector thread with 1/8" of thread past the nut. The side of the nut with the cross hatched groove is to face the knob.

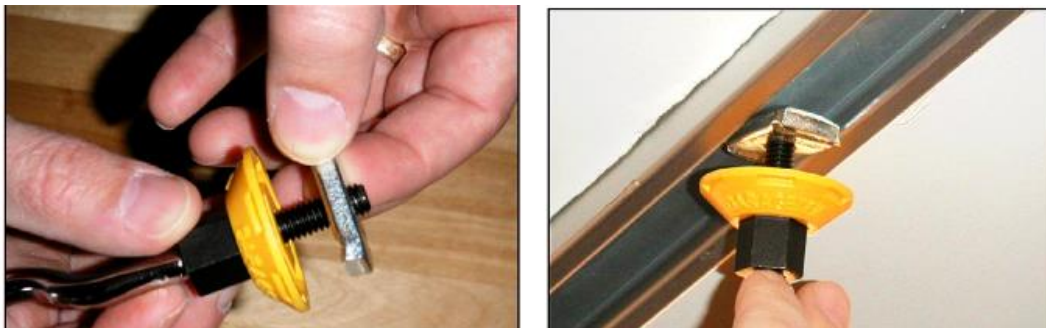

Step 4: Position the connector into the PowerTrack channel. The nut should be in line with the channel opening.

Step 5: Turn the channel nut 90 degrees, pull down and turn the connector until it is tightened and facing the desired direction. Pulling it down seats the nut groove into the channel and prevents it from turning when tightening.

If you have any questions or need some advice regarding your installation, please do get in touch and we will do our best to help.

You can contact us on:

01491 579975 | info@garageflex.co.uk
www.garageflex.co.uk

The logo for Garageflex features the word "Garageflex" in a bold, black, sans-serif font. Above the letters "a" and "e", there is a stylized orange outline of a house roof.

Unit 11 Westfield Farm
Medmenham
Buckinghamshire
SL7 2TA

01491 579975 | info@garageflex.co.uk
www.garageflex.co.uk